

235 58

235 58

Fori per impianti meccanici

235 58

120 58

110 295

110 295

110 295

PORTICO sup 56 mq h. 300
soffitto esistente c.a. faccia a vista
Pavimento gres simil pietra (R10)
60x60

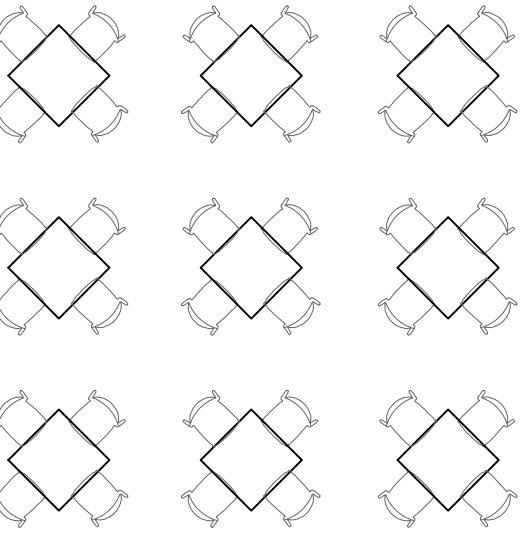

110 295

110 295

110 295

110 295

110 295

Soglie Biancone
Bocciardato Fine



U.S.

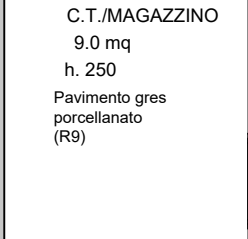
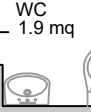
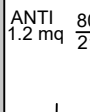
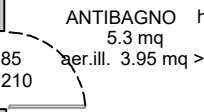
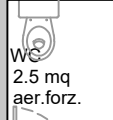
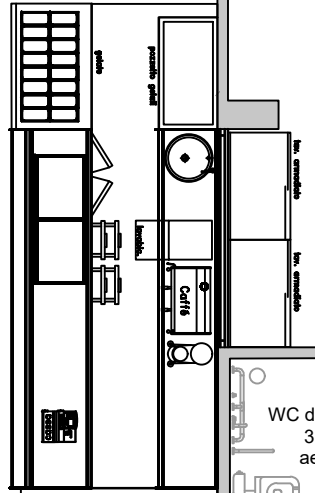

Rampa
Finitura gres simil pietra

Chiusura canna fumaria filo solaio

Intonaco armato

Intonachino colorato

Scalinata gres con frontale in pietra biancone come soglie

Intonachino colorato

Aerazione forzata bagni

Presenza elettrica e attacco acqua esterni

< 8%

85 210

105 64

105 64

110 295

110 295

110 295